



140 E. Main Street Lewisville, TX



Sundquist Plaza

3,500 sq. ft. rentable

*Special city incentives
for new retail and
resturant tenants*

Restaurant/Retail/Office

\$18.50 per sq. ft. Base Rent

*Part of the New Revitalized
Downtown Lewisville*

\$15.00 per sq. ft. Tenant
Improvements

Sundquist Plaza

140 E Main, Lewisville, TX

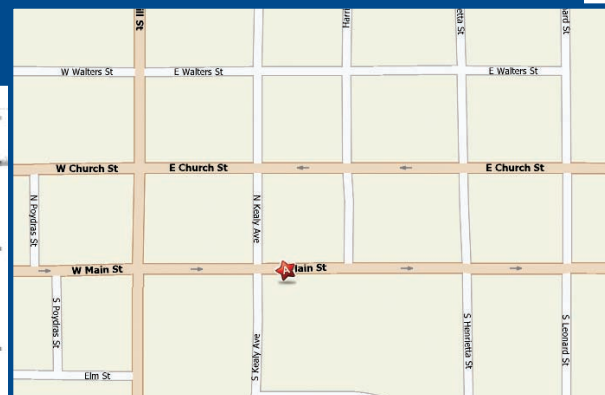
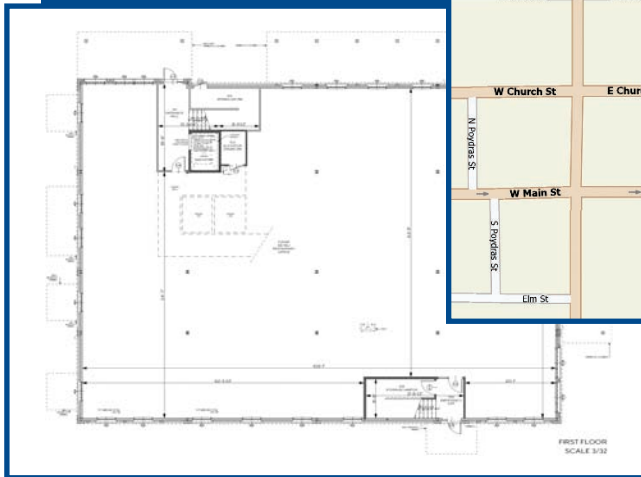

WEAVER
COMMERCIAL REAL ESTATE

for more information contact:

Todd Weaver
2901 Corporate Circle
Flower Mound, TX 75028

todd@weavercommercial.com
469-635-2833 Office
469-635-2849 Fax